

M12 Lens 2.9mm F2.0

SVL-IR02920B5M



Focal Length	2.9mm	Relative Illuminate	90
F Number	f2.0	TTL	26mm
Iris	Fixed	Suitable Distance	0.1-∞m
Mount	M12	Optimum working distance	∞m
Format	1/3"	Coating	400nm-950nm
IR Block	No IR Block	CRA	11.34°
Resolution	5MP	Operating Temp	-20°C~+60°C
Distortion	<49%	Dimensions	14 x 20.21mm
Back Focus	5.08mm	FOV (D x V x H)	D 129° V 110.7° H 61°
Wavelength	400nm-700nm	Lens Effective Diameter	Front 12mm Back 6.6mm

Size:

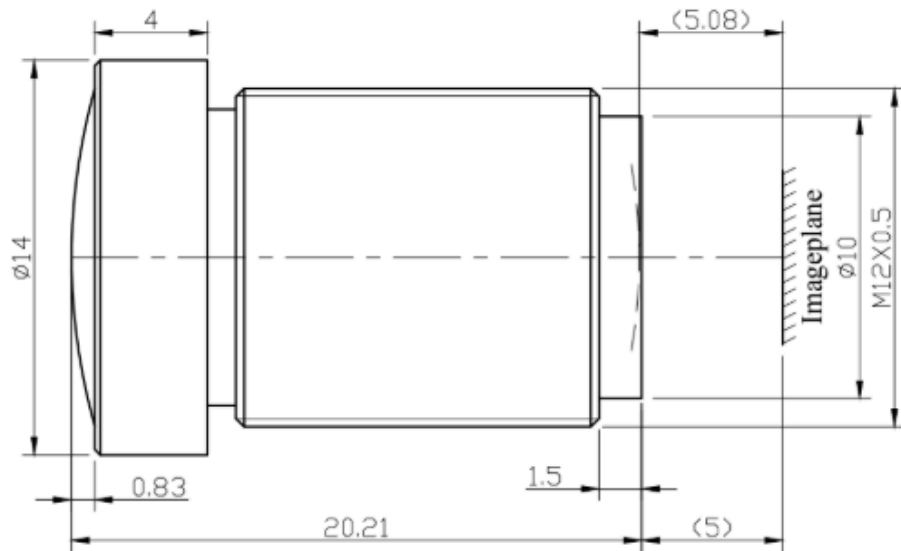

Unit:mm